

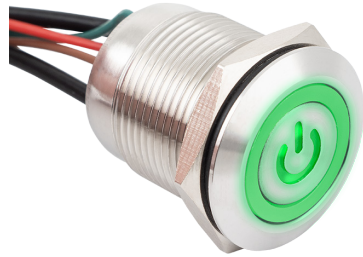

FLM19-FW-6-EC-Z-RDGN

Buton de putere mare, 10A, **bistabil**, Led semnalizare Rosu/Verde, filet M19, actionare prin apasare

Imagine



YLI ETERNIT ACCES srl
A.: HAIDUCULUI 3A, CLUJ-NAPOCA
T.: +40 264 484989
W.: www.yli.ro

FLM19-FW-6-EC-Z-RDGN
Buton de putere mare, 10A, **bistabil**, Led semnalizare
Rosu/Verde, filet M19, actionare prin apasare
FISA TEHNICIA

Descriere

Buton de putere mare, 10A, **bistabil**, Led semnalizare Rosu/Verde, filet M19, actionare prin apasare.

Caracteristici

- Buton cu actionare prin apasare
- Material: Otel inoxidabil
- Instalare: Incastrat
- Tip conectare: fire, lungime 20cm
- Suporturi compatibile: MP-28/19P, MP-35/19P, MP-86/19P

Specificatii tehnice

- | | |
|-------------------------------|----------------------------|
| • Actionare: | Prin apasare |
| • Sarcina maxima: | 10A @ 36Vcc
6A @ 250Vca |
| • Tip buton: | Bistabil |
| • Led semnalizare: | Rosu/Verde |
| • Alimentare Led: | 12Vcc |
| • Consum Led: | 6mA |
| • Montare: | Incastrat, filet M19 |
| • Testat la: | 100.000 apasari |
| • Protectie la intemperii: | IP67 |
| • Rezistent la socuri: | IK09 |
| • Temperatura de functionare: | -25° ~ +85°C |
| • Dimensiuni: | Ø22 x 24mm, filet M19 |
| • Greutate: | 27 g |

Conexiuni electrice

- | | |
|----------|--------------------|
| • Maro: | GND |
| • Rosu: | +12Vcc (Led rosu) |
| • Verde: | +12Vcc (Led verde) |
| • Negru: | COM |
| • Negru: | NO |

Dimensiuni

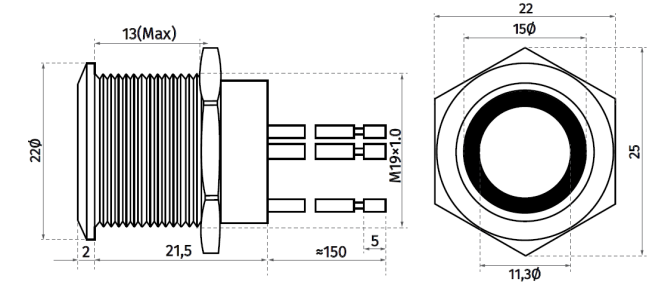

Observatii



EEE FAC OBIECTUL UNEI
COLECTARI SEPARATE

